

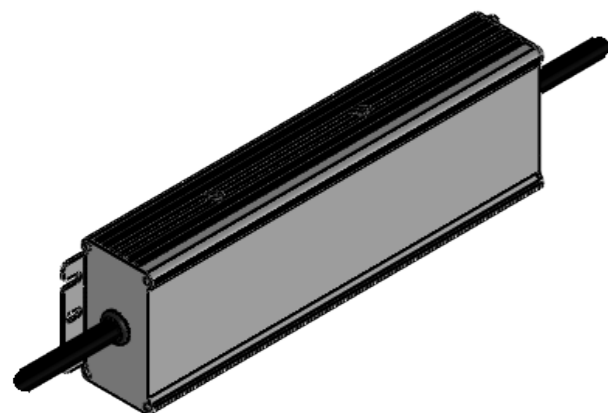

	L	B	H
ND-PS-XXX-40W-XXX-Y01	171 mm / 6,73 in	61,5 mm / 2,42 in	36,8 mm / 1,45 in
ND-PS-XXX-60W-XXX-Y01	171 mm / 6,73 in	61,5 mm / 2,42 in	36,8 mm / 1,45 in
ND-PS-XXX-80W-XXX-Y01	196 mm / 7,7 in	61,5 mm / 2,42 in	38,8 mm / 1,53 in
ND-PS-XXX-100W-XXX-Y01	220 mm / 8,66 in	68 mm / 2,68 in	38,8 mm / 1,53 in
ND-PS-XXX-120W-XXX-Y01	220 mm / 8,66 in	68 mm / 2,68 in	38,8 mm / 1,53 in
ND-PS-XXX-150W-XXX-Y01	228 mm / 8,98 in	68 mm / 2,68 in	38,8 mm / 1,53 in
ND-PS-XXX-185W-XXX-Y01	228 mm / 8,98 in	68 mm / 2,68 in	38,8 mm / 1,53 in
ND-PS-XXX-240W-XXX-Y01	244 mm / 9,62 in	68 mm / 2,68 in	38,8 mm / 1,53 in
ND-PS-XXX-320W-XXX-Y01	252 mm / 9,92 in	90 mm / 3,54 in	43,8 mm / 1,73 in
ND-PS-XXX-480W-XXX-Y01	262 mm / 10,32 in	125 mm / 4,92 in	43,8 mm / 1,73 in



Lindberghstrasse 15  
86343 Königsbrunn

Tel.: +49 8231 95787 0  
info@biontechnologies.com  
www.biontechnologies.com

Description Power Supply ND Series | nDIM

Date/Revision 13.01.2025/01

Scale 1:2

Dimensions are in **millimeters [inch]**  
All product specifications are subject to change without prior notice.

**NOTE:** All copyrights, trademarks, patents and other rights in connection herewith are expressly reserved to BION TECHNOLOGIES GMBH and no license is created or granted hereby.